

Net Internal Area Plan

RETAIL 364.3 sq m 3921 sq ft

TOTAL AREA: 364.3 sq m 3921 sq ft

The following areas have been EXCLUDED from the RETAIL Area:

Stairs 11.4 sq m 123 sq ft
Toilet 2.1 sq m 23 sq ft

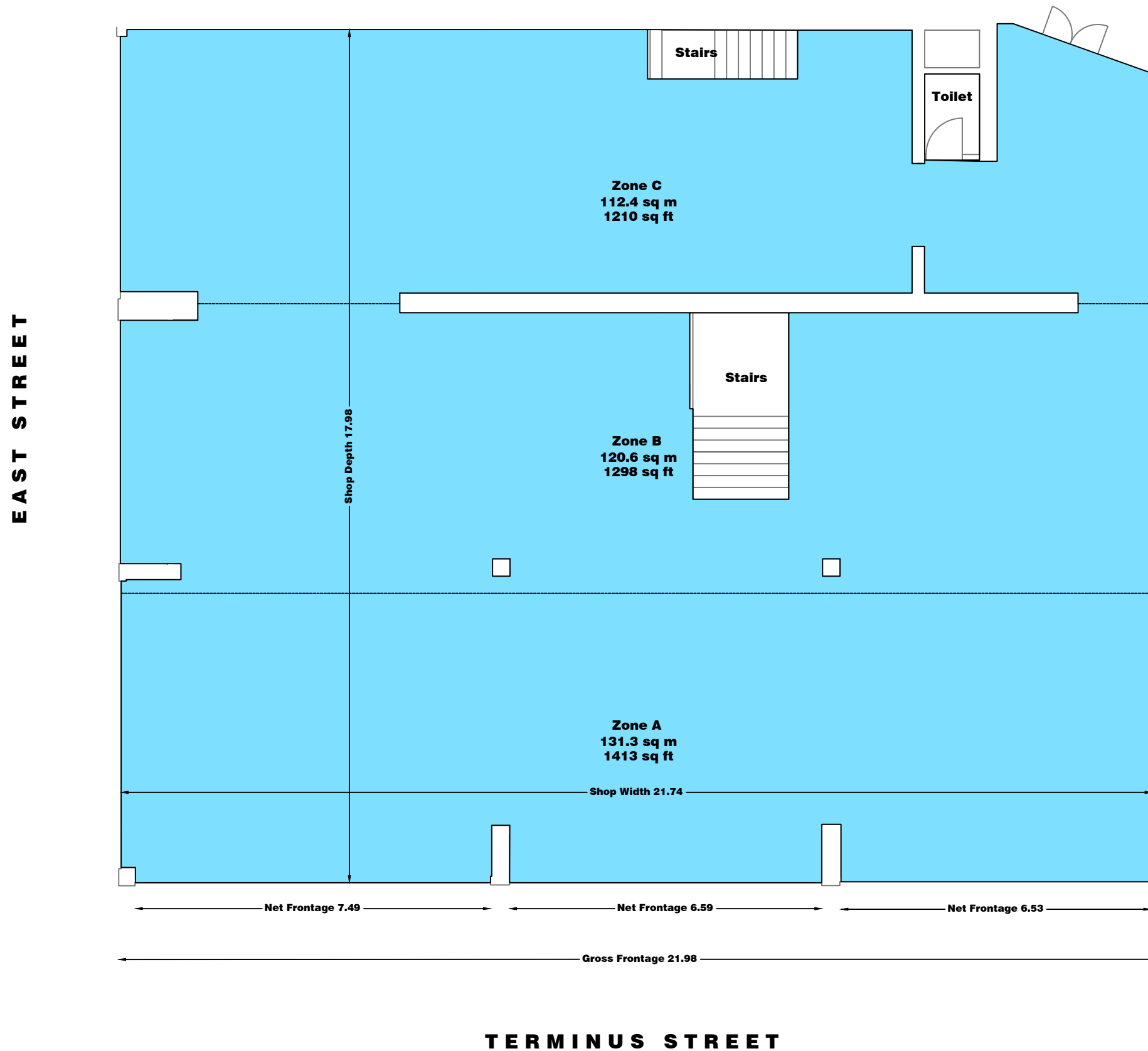

murphy London
9 Devonshire Square
London
EC2M 4YF
Asset Services
Phone: 020 3170 7026
Fax: 020 3178 6642

www.murphyassetservices.co.uk

Project : 22-24 TERMINUS STREET HARLOW, CM20	
Description : Ground Floor Area Plan	
Date : November 2011	Issue : A
Drawing Number : MSL3623-22-24TS-APG	
Scaled for presentation purposes	

Condition of Site:	Note/Notes	Revisions															
Occupied Vacant Heavy Fit-Out Shell & Core Under Construction Cat A Fit-Out	This drawing complies with the 6th edition of the RICS code and indicates the extent of the areas quoted, produced to an accuracy commensurate with standard presentation scales. It is held in a scaled digital CAD format.	<table border="1"> <thead> <tr> <th>No.</th> <th>Date</th> <th>Description</th> </tr> </thead> <tbody> <tr> <td>A</td> <td>10/11/2011</td> <td>First Drawing</td> </tr> <tr> <td> </td> <td> </td> <td> </td> </tr> <tr> <td> </td> <td> </td> <td> </td> </tr> <tr> <td> </td> <td> </td> <td> </td> </tr> </tbody> </table>	No.	Date	Description	A	10/11/2011	First Drawing									
No.	Date	Description															
A	10/11/2011	First Drawing															